

Multi-Layer Tower Lamps

Universal • Economical
Lampshade Diameter Ø50, 3 Layers

Code	Type	Lampshade Diameter
ZHD50	Universal	Ø50

Features

- Exquisite structure, high cost performance;
- Good heat dissipation ensure product service life.

CE CCC



A(Foldable Type)

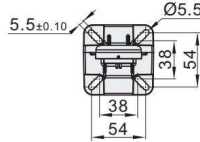
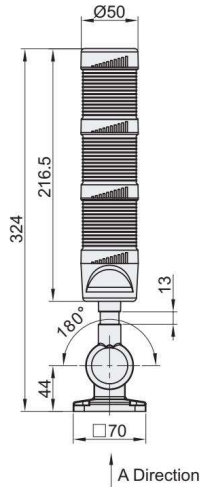

A Direction View

C(Rod Disc Type)

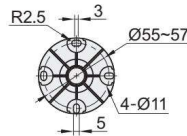
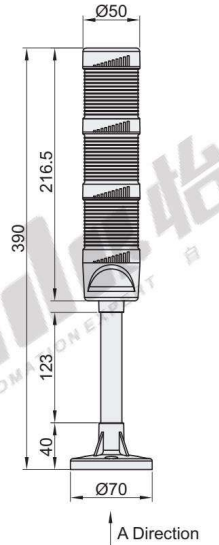

A Direction View

Wiring Diagram

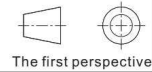
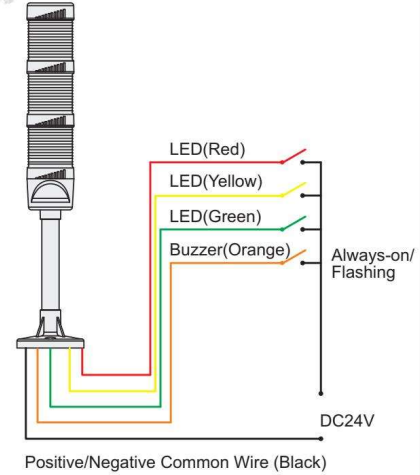

The first perspective

Part Number		Mounting Method	Function	Color (From Top)	Lampshade Diameter (Ø)	Rated Voltage	Wiring Method	IP Rating
Code	Number of Layers							
ZHD50	3(3 Layers)	A(Foldable) C(Rod Disc Type)	B(Always-on) F(Always-on With Beep)	RYG (Red Yellow Green)	50	DC24V	Direct Power Input Type (Common Positive/Negative Universal)	IP54



Please order as shown

Part Number	Mounting Method	Function	Color
Code	Number of Layers		
ZHD50	3(3 Layers)	A(Foldable) C(Rod Disc Type)	B F (Red Yellow Green)

ZHD50-3-A-B-RYG

Basic Parameters

Input Voltage	DC24V
Input Current	50~200mA
Power Consumption	Single colour 1.5W, total power less than 5W
Wire Length	About 0.5M
Light	SMD 2835 LED 0.2W/PCS
Lamp Life	The light life is 100,000 hours, and the whole lamp life is 50,000 hours
Exterior Design	Round, Modular shades
Lamp Body Color	White
Material	PC (Bulletproof Rubber), Engineering Plastics, etc.
Outgoing Light Angle	360-degree visibility

Environmental Requirements

Operating Temperature	-20~45°C
Storage Temperature	-40~70°C
Operating Humidity	10~90%
Storage Humidity	10~90%

Tower Lights